

Eye Foundry Hook – Grade 80 - design factor 4:1 - Cert supplied on request

Grade 80 Chain	WLL / lbs	Dimensions (inch)						Wt. lbs	Pcs Box	Part Number
		A	D	H	K	P	T			
3/8	7,100	1.26	0.59	1.34	5.91	2.87	0.94	2.9	12	28-3/8FEH
1/2	12,000	1.56	0.75	1.65	7.09	3.50	1.34	5.3	8	28-1/2FEH
5/8	18,100	1.96	0.98	1.97	8.46	3.94	1.63	8.8	4	28-5/8FEH
3/4	28,300	2.36	1.20	2.25	9.76	4.41	1.81	20.7	3	28-3/4FEH

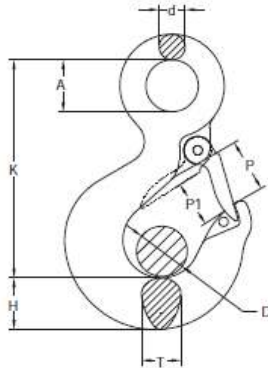
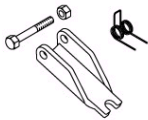

Eye Hoist Hook -Grade 80 - design factor 5:1 - Maximum Proof Load is 2 x WLL - Cert supplied on request

WLL tonnes	Latch Kit		Dimensions (inch)						Wt lbs	Pcs Box	Part Number
	Price	Part Number	A	D	H	K	P	T			
2	9.83	28-2TLK	1.14	0.79	1.02	4.17	0.79	0.83	1.5	20	28-2TEHH
3	9.83	28-3TLK	1.26	0.98	1.14	4.80	0.98	0.95	2.0	15	28-3TEHH
5	13.61	28-5TLK	1.57	1.22	1.46	5.87	1.22	1.22	4.6	10	28-5TEHH
7	21.64	28-7TLK	2.00	1.54	1.85	7.56	1.54	1.46	8.8	4	28-7TEHH

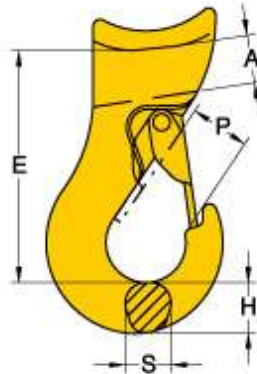
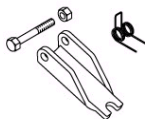

Sliding Choker Hook – Grade 80 - design factor 5:1 - Cert supplied on request

WLL / lbs	Wire Rope	Latch Kit		Dimensions (inch)					Wt. Lbs	Pcs box	Part Number
		Price	Part #	A	E	H	P	S			
3,400	3/8-1/2	10.40	28-8074LK	0.63	3.43	0.94	0.71	0.71	1.3	25	28-9-13SCH
5,200	9/16-5/8	10.40	28-8074LK	0.83	3.86	1.14	0.79	0.87	2.0	20	28-14-16SCH

****See Page 14 for Grade 80 Chain****

